

Union County Structures

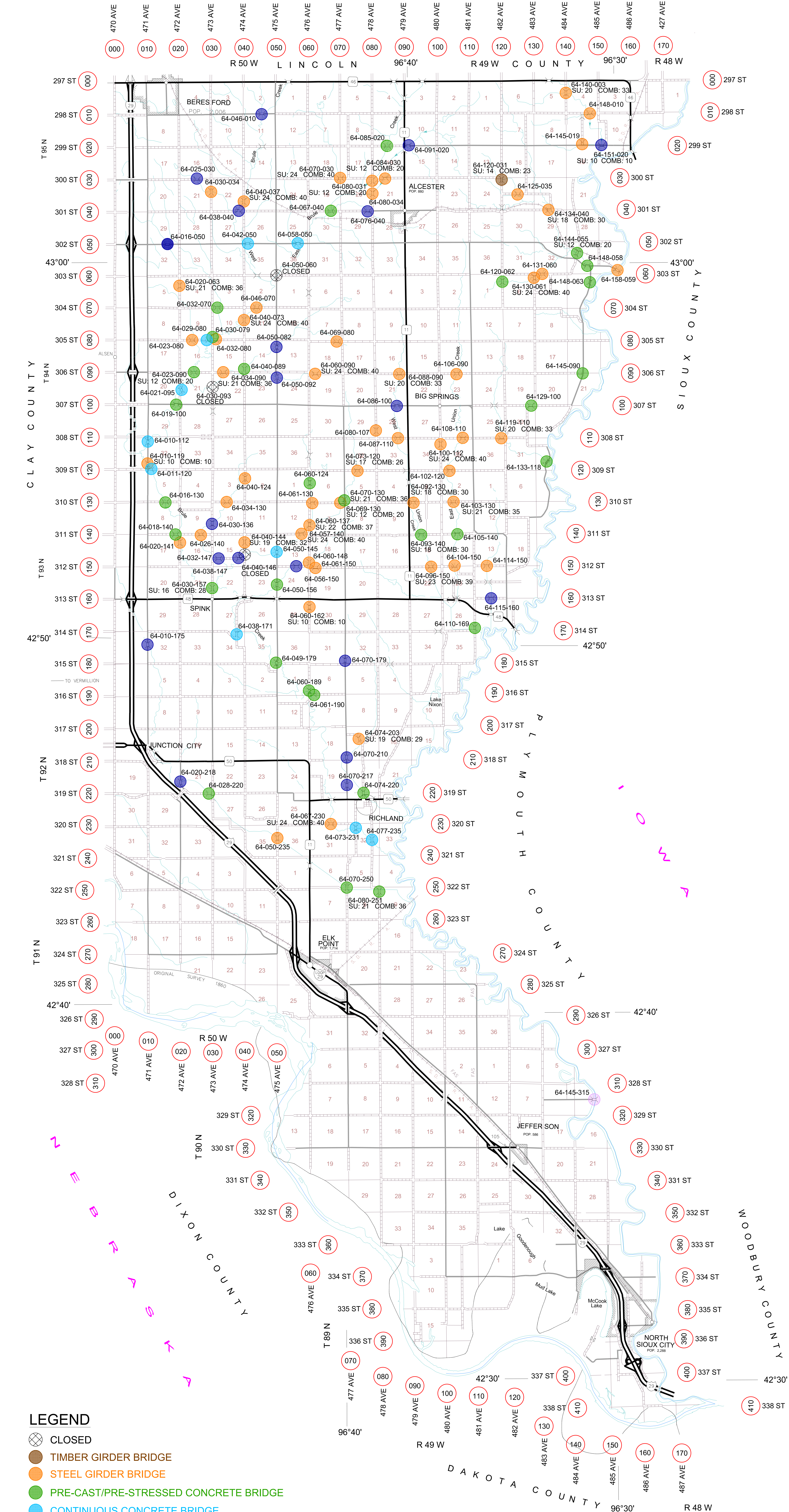

- LEGEND**
- CLOSED
 - TIMBER GIRDER BRIDGE
 - STEEL GIRDER BRIDGE
 - PRE-CAST/PRE-STRESSED CONCRETE BRIDGE
 - CONTINUOUS CONCRETE BRIDGE
 - CONCRETE BOX/PIPE CULVERT
 - UNION COUNTY / PLYMOUTH COUNTY, IOWA COST SHARE
 - C CONSTRUCTION YEAR
 - RC RECONSTRUCTION YEAR
 - SR SUFFICIENCY RATING
 - POSTED EXISTING POSTING
 - POST RECOMMENDED POSTING
 - LC LOAD RATING PERCENT BELOW LEGAL CAPACITY
- NOTES: 2016 RECOMMENDED POSTINGS AND SUFFICIENCY RATINGS SHOWN
SU - SINGLE UNIT COMB - COMBINATION

JOHNSON ENGINEERING COMPANY
CIVIL ENGINEERS | LAND SURVEYORS
Est. 1956
1800 Broadway Avenue, Suite 3
Yankton, South Dakota 57078
(605) 665-5571

- 64-010-112 SIZE AND TYPE TO BE DETERMINED
10.2 S OF BERESFORD C: 2016 SR: 77.5
BRIDGE UNDER CONSTRUCTION IN 2016
64-010-119 122.0' X 33.3' THREE SPAN STEEL GIRDER BRIDGE
10.3 S OF BERESFORD C: 1939 SR: 37.7
POSTED: SU: 10 COMB: 10 POST: SU: 10 COMB: 10 LC: 58-78%
64-010-175 4-8' X 3' REINFORCED CONCRETE BOX CULVERT
16.5 S OF BERESFORD C: 1955 SR: 96.9
64-011-120 132.0' X 30.3' THREE SPAN CONTINUOUS CONCRETE BRIDGE 25° SKEW RHF
11.3 S OF BERESFORD C: 1989 SR: 98.0
64-016-050 2-10' X 8' REINFORCED CONCRETE BOX CULVERT
5 S OF BERESFORD C: 1960 SR: 81.6
64-016-130 12.0' X 23.0' TWO SPAN PRE-CAST CONCRETE CHANNEL BRIDGE
12.5, 0.4 E OF BERESFORD C: 1970 SR: 77.8
64-018-140 90.0' X 32.8' SINGLE SPAN PRE-STRESSED DOUBLE T BRIDGE
13.5, 0.8 E OF BERESFORD C: 1989 SR: 90.0
64-019-100 97.4' X 32.9' SINGLE SPAN PRE-STRESSED DOUBLE T BRIDGE
1.5 S, 2 E OF ALSEN C: 2013 SR: 97.9
64-020-063 22.2' X 22.1' SINGLE SPAN STEEL GIRDER BRIDGE
5.3 S OF BERESFORD C: 1973 SR: 57.1
POSTED: SU: 21 COMB: 36 POST: SU: 21 COMB: 36 LC: 10-13%
64-020-141 80.4' X 28.0' SINGLE SPAN STEEL GIRDER BRIDGE
1.3 S OF BERESFORD C: 1985 SR: 81.4
64-020-218 21.3' X 10' REINFORCED CONCRETE BOX CULVERT
4 W, 5.2 N OF ELK POINT C: 2006 SR: 99.4
112.5' X 30.5' THREE SPAN CONTINUOUS CONCRETE BRIDGE
6.5 S OF BERESFORD C: 1989 SR: 86.0
64-023-080 32.3' X 28.0' SINGLE SPAN STEEL GIRDER BRIDGE
7.5, 0.3 E OF BERESFORD C: 1987 SR: 78.8
64-023-090 16.7' X 28.2' TWO SPAN PRE-STRESSED DOUBLE T BRIDGE
8 S, 0.3 E OF BERESFORD C: 1979 SR: 42.4
POSTED: SU: 12 COMB: 20 POST: SU: 12 COMB: 20 LC: 50-52%
64-025-030 26.7' X 28.0' TWO SPAN STEEL GIRDER BRIDGE
13.5, 0.6 E OF BERESFORD C: 1989 SR: 90.0
64-026-140 50.3' X 25.5' TWO SPAN PRE-CAST CONCRETE CHANNEL BRIDGE
5 N, 3.2 W OF ELK POINT C: 1940 RC: 1988 SR: 78.8
64-028-220 96.6' X 28.1' THREE SPAN CONTINUOUS CONCRETE BRIDGE
8 S, 1.2 E OF BERESFORD C: 1994 SR: 98.0
64-030-034 31.7' X 28.0' TWO SPAN STEEL GIRDER BRIDGE
1.1, 2.4 S OF BERESFORD C: 1991 SR: 89.0
64-030-079 72.0' X 20.9' TWO SPAN PRE-CAST CONCRETE CHANNEL BRIDGE
1.1, 6.9 S OF BERESFORD C: 1940 RC: 1987 SR: 88.7
64-030-093 24.5' X 24.3' SINGLE SPAN STEEL GIRDER BRIDGE
1 E, 8.3 S OF BERESFORD C: 1978 SR: 40.0
POSTED: SU: 12 COMB: 20 POST: CLOSE BRIDGE
64-030-136 2-10' X 5' CAST IN PLACE REINFORCED CONCRETE BOX CULVERT
1 E, 12.6 S OF BERESFORD C: 1950 SR: 97.0
64-030-157 98.0' X 26.0' TWO SPAN PRE-STRESSED DOUBLE T BRIDGE
1 E, 14.7 S OF BERESFORD C: 1976 SR: 50.5
POSTED: SU: 16 COMB: 28 POST: SU: 16 COMB: 28 LC: 30-33%
64-032-070 25.0' X 19.3' SINGLE SPAN PRE-CAST CONCRETE CHANNEL BRIDGE
6 S, 1.2 E OF BERESFORD C: 1970 RC: 1983 SR: 74.8
64-032-080 60.4' X 28.0' TWO SPAN STEEL GIRDER BRIDGE
5 S, 2.2 E OF BERESFORD C: 1989 SR: 90.0
64-032-147 2-10' X 6' CAST IN PLACE REINFORCED CONCRETE BOX CULVERT
13.7 S, 1.2 E OF BERESFORD C: 1950 SR: 97.0
64-034-090 31.8' X 28.1' SINGLE SPAN STEEL GIRDER BRIDGE
8 S, 1.4 E OF BERESFORD C: 1948 RC: 1988 SR: 63.7
POSTED: SU: 21 COMB: 36 POST: SU: 21 COMB: 36 LC: 8-13%
64-034-130 30.0' X 28.0' SINGLE SPAN STEEL GIRDER BRIDGE
12.3, 1.4 E OF BERESFORD C: 1955 SR: 77.5
64-038-040 2-14' X 8' CAST IN PLACE REINFORCED CONCRETE BOX CULVERT
1 E, 6 S OF BERESFORD C: 2010 SR: 80.8
64-038-147 2-14' X 7' REINFORCED CONCRETE BOX CULVERT 45° SKEW LHF
13.7 S, 1.8 E OF BERESFORD C: 2007 SR: 100.0
64-038-171 107.0' X 30.7' THREE SPAN CONTINUOUS CONCRETE BRIDGE
1.8 E, 16.1 S OF BERESFORD C: 1986 SR: 97.0
64-040-037 46.8' X 27.9' TWO SPAN STEEL GIRDER BRIDGE
2 E, 2.7 S OF BERESFORD C: 1982 SR: 74.6
POSTED: SU: 24 COMB: 40 POST: SU: 24 COMB: 40 LC: 0-12%
64-040-073 60.7' X 28.3' TWO SPAN STEEL GIRDER BRIDGE
2 E, 6.3 S OF BERESFORD C: 1986 SR: 68.9
64-040-089 41.0' X 28.1' SINGLE SPAN PRE-STRESSED DOUBLE T BRIDGE
2 E, 7.9 S OF BERESFORD C: 1983 SR: 78.8
64-040-124 22.3' X 27.7' SINGLE SPAN STEEL GIRDER BRIDGE 15° SKEW RHF
2 E, 11.4 S OF BERESFORD C: 1970 SR: 78.8
64-040-144 25.0' X 24.2' SINGLE SPAN STEEL GIRDER BRIDGE 30° SKEW RHF
POSTED: NONE POST: SU: 12 COMB: 20
64-040-146 24.8' X 29.0' SINGLE SPAN STEEL GIRDER BRIDGE
2 E, 13.6 S OF BERESFORD C: 1945 RC: 1987 SR: 41.0
POSTED: SU: 5 COMB: 5
64-042-050 105.5' X 34.3' FIVE SPAN CONTINUOUS CONCRETE BRIDGE
1.8 W, 1.3 S OF ALCESTER C: 1960 SR: 92.7
64-046-010 3-11' X 6' CAST IN PLACE REINFORCED CONCRETE BOX CULVERT 23° SKEW LHF
2.6 E OF BERESFORD C: 2008 SR: 92.7
64-046-070 61.0' X 23.0' TWO SPAN STEEL GIRDER BRIDGE 30° SKEW RHF
6 S, 2.6 E OF BERESFORD C: 1987 SR: 72.4
64-049-179 120.3' X 30.9' THREE SPAN PRE-STRESSED DOUBLE T BRIDGE 30° SKEW LHF
1.5 N, 4 E OF JUNCTION CITY C: 1977 SR: 78.8
64-050-060 68.7' X 31.9' TWO SPAN PRE-CAST CONCRETE CHANNEL BRIDGE 30° SKEW RHF
4 W, 2 E OF ALCESTER C: 1960 SR: 36.0
POSTED: SU: 6 COMB: 10 POST: CLOSE BRIDGE
64-050-082 2-14' X 5' CAST IN PLACE REINFORCED CONCRETE BOX CULVERT
1 W, 4.2 S OF ALCESTER C: 2009 SR: 100.0
64-050-092 3-10' X 8' REINFORCED CONCRETE BOX CULVERT WIDENED WITH
ONE PRE-CAST CONCRETE CHANNEL ON EACH SIDE
1 W, 5.2 S OF ALCESTER C: 1935 RC: 1971 SR: 92.7
64-050-145 30.0' X 26.0' TWO SPAN CONTINUOUS CONCRETE BRIDGE
2 E, 1.5 N OF SPINK C: 1939 SR: 89.7
64-050-156 35.0' X 31.0' SINGLE SPAN PRE-STRESSED DOUBLE T BRIDGE
2 E, 0.5 N OF SPINK C: 2000 SR: 90.0
64-050-235 64.7' X 29.3' SINGLE SPAN STEEL GIRDER BRIDGE
1 W, 3.3 N OF ELK POINT C: 1983 SR: 80.0
64-056-150 2-10' X 8' CAST IN PLACE REINFORCED CONCRETE BOX CULVERT 20° SKEW LHF
14.5, 3.6 E OF BERESFORD C: 2007 SR: 100.0
64-057-140 60.7' X 28.0' SINGLE SPAN STEEL GIRDER BRIDGE
13.5, 3.7 E OF BERESFORD C: 1955 RC: 1974 SR: 70.2
POSTED: SU: 24 COMB: 40 POST: SU: 24 COMB: 40 LC: 0-15%
64-059-050 140.0' X 34.3' FIVE SPAN CONTINUOUS CONCRETE BRIDGE
3.2 W, 1 S OF ALCESTER C: 1960 SR: 87.5
64-060-090 23.3' X 26.0' SINGLE SPAN STEEL GIRDER BRIDGE 25° SKEW RHF
1.8 S OF BERESFORD C: 1985 RC: 1987 SR: 71.3
POSTED: SU: 24 COMB: 40 POST: SU: 24 COMB: 40 LC: 0-12%
64-060-124 35.7' X 26.8' SINGLE SPAN PRE-STRESSED DOUBLE T BRIDGE
1 E, 11.4 S OF BERESFORD C: 2016 SR: 100.0
64-060-137 55.7' X 29.1' SINGLE SPAN STEEL GIRDER BRIDGE
POSTED: SU: 22 COMB: 37 POST: SU: 22 COMB: 37 LC: 8-23%
64-060-148 36.3' X 27.0' SINGLE SPAN STEEL GIRDER BRIDGE
4 E, 1.2 N OF SPINK C: 1993 SR: 80.0
64-060-162 22.0' X 23.0' SINGLE SPAN STEEL GIRDER BRIDGE
4 E, 19.2 S OF BERESFORD C: 1989 SR: 39.0
64-060-189 60.6' X 19.3' SINGLE SPAN PRE-STRESSED DOUBLE T BRIDGE
POSTED: SU: 10 COMB: 10 POST: SU: 10 COMB: 10 LC: 58-78%
64-061-130 8.1' N OF ELK POINT C: 2004 SR: 87.8
64-061-150 23.9' X 28.9' SINGLE SPAN STEEL GIRDER BRIDGE
3 E, 1 N OF SPINK C: 1992 SR: 89.3
64-061-190 110.0' X 30.5' SINGLE SPAN PRE-STRESSED CONCRETE GIRDER BRIDGE 20° SKEW LHF
8 N, 0.1 E OF ELK POINT C: 2006 SR: 98.0
64-067-040 74.3' X 28.2' TWO SPAN PRE-STRESSED DOUBLE T BRIDGE
1.8 W OF ALCESTER C: 1944 RC: 1977 SR: 78.8
64-067-230 74.3' X 24.1' SINGLE SPAN STEEL GIRDER BRIDGE
4 N, 0.7 E OF ELK POINT C: 2005 SR: 89.8
POSTED: NONE POST: SU: 24 COMB: 40 LC: 0-11%
64-069-080 40.6' X 24.0' TWO SPAN STEEL GIRDER BRIDGE
7 S, 4.9 E OF BERESFORD C: 1989 SR: 88.8
64-069-130 25.0' X 23.0' SINGLE SPAN STEEL GIRDER BRIDGE 30° SKEW LHF
1.1 W OF ALCESTER C: 1940 RC: 1978 SR: 42.4
64-070-030 26.8' X 28.5' SINGLE SPAN STEEL GIRDER BRIDGE
POSTED: SU: 12 COMB: 20 POST: SU: 12 COMB: 20 LC: 45-52%
64-070-130 25.8' X 29.0' SINGLE SPAN PRE-CAST CONCRETE CHANNEL BRIDGE
3.5 S, 2 W OF ALCESTER C: 1989 SR: 72.4
POSTED: NONE POST: SU: 21 COMB: 36 LC: 10-13%
64-070-179 3-8' X 4' REINFORCED CONCRETE BOX CULVERT
4.3 N OF JCT SD 50 C: 1955 SR: 75.3
64-070-210 3-10' X 8' REINFORCED CONCRETE BOX CULVERT
1.2 N OF JCT SD 50 C: 1948 SR: 96.7
64-070-217 3-10' X 8' REINFORCED CONCRETE BOX CULVERT
0.5 N OF JCT SD 50 C: 1948 SR: 96.7
64-070-250 62.5' X 25.7' TWO SPAN PRE-CAST CONCRETE CHANNEL BRIDGE
1 E, 2 W OF ELK POINT C: 1988 SR: 78.8
64-073-120 32.8' X 24.3' SINGLE SPAN STEEL GIRDER BRIDGE
1 E, 7 W OF ALCESTER C: 1977 SR: 41.7
64-073-231 100.0' X 32.4' THREE SPAN CONTINUOUS CONCRETE BRIDGE 10° SKEW LHF
4.9 N, 1.3 E OF ELK POINT C: 1997 SR: 100.0
64-074-023 40.8' X 20.2' TWO SPAN STEEL GIRDER BRIDGE
1 E, 6.7 N OF ELK POINT C: 1990 SR: 39.0
POSTED: SU: 19 COMB: 29 POST: SU: 19 COMB: 29 LC: 19-37%
64-074-220 26.0' X 28.1' SINGLE SPAN PRE-STRESSED DOUBLE T BRIDGE 30° SKEW LHF
3 N, 2 E OF ELK POINT C: 1977 SR: 88.8
64-076-040 2-13' X 8' REINFORCED CONCRETE BOX CULVERT
1 W OF ALCESTER C: 2004 SR: 100.0
64-077-235 97.0' X 28.1' THREE SPAN CONTINUOUS CONCRETE BRIDGE
1.4 S OF RICHLAND C: 1983 SR: 89.3
64-080-031 60.5' X 28.0' TWO SPAN STEEL GIRDER BRIDGE
0.5 W, 0.9 N OF ALCESTER C: 1983 SR: 55.4
POSTED: SU: 12 COMB: 20 POST: SU: 12 COMB: 20 LC: 50-52%
64-080-034 40.3' X 28.4' SINGLE SPAN STEEL GIRDER BRIDGE
0.5 W, 0.8 N OF ALCESTER C: 1983 SR: 56.5
64-080-107 23.0' X 21.0' SINGLE SPAN STEEL GIRDER BRIDGE 15° LHF
1 W, 6.7 S OF ALCESTER C: 1940 RC: 1973 SR: 83.7
64-080-251 62.1' X 22.7' TWO SPAN PRE-CAST CONCRETE CHANNEL BRIDGE
1.9 N OF ELK POINT C: 1940 RC: 1988 SR: 81.4
POSTED: SU: 21 COMB: 36 POST: SU: 21 COMB: 36 LC: 10-13%
64-084-030 33.0' X 28.0' TWO SPAN STEEL GIRDER BRIDGE
1 N, 0.8 W OF ALCESTER C: 1987 SR: 41.0
POSTED: SU: 12 COMB: 20 POST: SU: 12 COMB: 20 LC: 50-52%
64-085-020 72.3' X 25.5' TWO SPAN PRE-CAST CONCRETE CHANNEL BRIDGE
2 N, 0.5 W OF ALCESTER C: 1930 SR: 78.8
64-086-100 3-8' X 3' REINFORCED CONCRETE BOX CULVERT
6 S, 0.4 W OF ALCESTER C: 1980 SR: 96.9
64-087-110 40.3' X 28.0' SINGLE SPAN STEEL GIRDER BRIDGE
7 S, 0.3 W OF ALCESTER C: 1957 RC: 1981 SR: 92.2
64-088-090 92.3' X 26.1' SINGLE SPAN STEEL GIRDER BRIDGE
5 S, 0.2 W OF ALCESTER C: 1950 RC: 1970 SR: 47.7
POSTED: SU: 20 COMB: 33 POST: SU: 20 COMB: 33 LC: 15-41%
64-091-020 63.3' X 24.0' SINGLE SPAN STEEL GIRDER BRIDGE
6 S, 1.2 E OF ALCESTER C: 1940 RC: 1977 SR: 43.7
POSTED: SU: 18 COMB: 30 POST: SU: 18 COMB: 30 LC: 25-46%
64-093-140 40.6' X 28.1' SINGLE SPAN PRE-STRESSED DOUBLE T BRIDGE 30° SKEW RHF
1.5 S, 0.3 E OF ALCESTER C: 1981 SR: 81.4
POSTED: SU: 18 COMB: 30 POST: SU: 18 COMB: 30 LC: 25-26%
64-096-150 79.3' X 27.8' SINGLE SPAN STEEL GIRDER BRIDGE
11.5, 0.6 E OF ALCESTER C: 1986 SR: 63.0
64-100-112 24.9' X 22.4' SINGLE SPAN STEEL GIRDER BRIDGE
POSTED: SU: 23 COMB: 39 POST: SU: 23 COMB: 39 LC: 3-17%
64-102-120 48.0' X 28.0' SINGLE SPAN STEEL GIRDER BRIDGE
7.5 S, 1.2 E OF ALCESTER C: 1950 RC: 1983 SR: 80.7
64-103-130 42.8' X 25.3' SINGLE SPAN STEEL GIRDER BRIDGE 30° SKEW RHF
1.5 E, 3.6 E OF ALCESTER C: 1949 RC: 1978 SR: 69.7
POSTED: SU: 21 COMB: 35 POST: SU: 21 COMB: 35 LC: 13-38%
64-104-150 30.8' X 28.0' SINGLE SPAN STEEL GIRDER BRIDGE
10.5 S, 1.4 E OF ALCESTER C: 1950 SR: 79.4
64-105-140 60.6' X 25.4' TWO SPAN PRE-CAST CONCRETE CHANNEL BRIDGE
9.5 S, 1.5 E OF ALCESTER C: 1960 RC: 1975 SR: 58.7
64-106-090 27.3' X 28.0' SINGLE SPAN STEEL GIRDER BRIDGE
4 S, 1.6 E OF ALCESTER C: 1986 SR: 70.0
64-108-110 32.2' X 22.0' SINGLE SPAN STEEL GIRDER BRIDGE
5.5 S, 1.8 E OF ALCESTER C: 1988 SR: 80.0
64-110-169 100.6' X 31.0' THREE SPAN PRE-STRESSED DOUBLE T BRIDGE
10.1 N, 5 E OF ELK POINT C: 1978 SR: 99.7
64-114-150 24.7' X 27.8' SINGLE SPAN STEEL GIRDER BRIDGE
10.5 S, 2.4 E OF ALCESTER C: 1940 RC: 1975 SR: 78.5
64-115-160 2-10' X 7' REINFORCED CONCRETE BOX CULVERT
11.5 S, 2.5 E OF ALCESTER C: 1980 SR: 92.8
64-119-110 26.0' X 21.4' SINGLE SPAN STEEL GIRDER BRIDGE
6.5 S, 0.9 E OF ALCESTER C: 1940 SR: 61.0
POSTED: SU: 20 COMB: 33 POST: SU: 20 COMB: 33 LC: 17-40%
64-120-031 24.8' X 27.0' TWO SPAN TIMBER GIRDER BRIDGE 15° SKEW LHF
5 E, 0.9 N OF ALCESTER C: 1982 SR: 46.5
POSTED: SU: 23 COMB: 40 POST: SU: 14 COMB: 23 LC: 42-48%
64-120-062 25.6' X 25.5' SINGLE SPAN PRE-CAST CONCRETE CHANNEL BRIDGE
5 E, 2.2 S OF ALCESTER C: 1983 SR: 63.8
64-125-035 45.0' X 21.4' TWO SPAN STEEL GIRDER BRIDGE 30° SKEW RHF
3.5 E, 0.5 N OF ALCESTER C: 1991 SR: 65.6
64-129-100 25.5' X 26.9' SINGLE SPAN PRE-STRESSED DOUBLE T BRIDGE
5.5 S, 3.9 E OF ALCESTER C: 1977 SR: 89.8
64-130-061 26.5' X 28.2' TWO SPAN STEEL & TIMBER GIRDER BRIDGE
5 E, 2.1 S OF ALCESTER C: 1981 SR: 61.0
POSTED: SU: 24 COMB: 40 POST: SU: 24 COMB: 40 LC: 0-11%
64-131-060 40.8' X 25.0' SINGLE SPAN STEEL GIRDER BRIDGE 15° SKEW LHF
1.5 S, 1.4 E OF ALCESTER C: 1989 SR: 91.9
64-133-118 51.0' X 28.2' SINGLE SPAN PRE-STRESSED DOUBLE T BRIDGE
4 E, 1.7 S OF BIG SPRINGS C: 1979 SR: 85.4
64-134-040 40.3' X 28.1' SINGLE SPAN STEEL GIRDER BRIDGE
3.4 E OF ALCESTER C: 1950 RC: 1978 SR: 42.0
POSTED: SU: 18 COMB: 30 POST: SU: 18 COMB: 30 LC: 25-48%
64-140-003 40.3' X 28.1' SINGLE SPAN STEEL GIRDER BRIDGE
12 E, 0.3 S OF BERESFORD C: 1983 SR: 71.4
64-144-055 62.6' X 22.2' TWO SPAN PRE-CAST CONCRETE CHANNEL BRIDGE
5.4 E, 1.5 S OF ALCESTER C: 1947 RC: 1975 SR: 39.9
POSTED: SU: 12 COMB: 20 POST: SU: 12 COMB: 20 LC: 50-52%
64-145-019 27.8' X 25.2' TWO SPAN STEEL GIRDER BRIDGE
12.5 E, 0.9 S OF BERESFORD C: 1992 SR: 85.0
64-145-090 36.9' X 31.0' SINGLE SPAN PRE-CAST CONCRETE CHANNEL BRIDGE
5 S, 5.5 E OF ALCESTER C: 1989 RC: 2000 SR: 90.8
64-148-010 55.8' X 29.0' SINGLE SPAN STEEL GIRDER BRIDGE
12.6 E OF BERESFORD C: 1987 SR: 97.0
64-148-059 60.9' X 35.0' SINGLE SPAN PRE-STRESSED DOUBLE T BRIDGE
1.8 S, 5.8 E OF ALCESTER C: 1985 SR: 65.6
64-148-063 36.6' X 27.8' SINGLE SPAN PRE-CAST CONCRETE CHANNEL BRIDGE 30° SKEW LHF
2 S, 5.3 E OF ALCESTER C: 1972 RC: 2001 SR: 75.7
64-151-020 3-7' X 7' CORRUGATED METAL PIPE
1.1 N OF ALCESTER C: 1972 SR: 49.3
POSTED: SU: 10 COMB: 10 POST: SU: 10 COMB: 10 LC: 58-78%
64-158-059 67.9' X 34.3' FIVE SPAN STEEL PLATE GIRDER BRIDGE 30° SKEW LHF
6.5 E, 1.9 S OF ALCESTER C: 1973 SR: 77.1